

These wagons were constructed by LHB in Germany. The wagons are internationally registered in the UK and Germany and meet all existing RIV / UIC regulations. They are also approved for Channel tunnel operation. The wagons have been designed primarily for the conveyance of palletised goods but can accommodate most forms of general cargo.

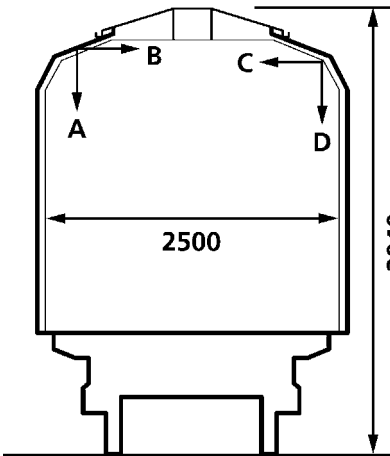
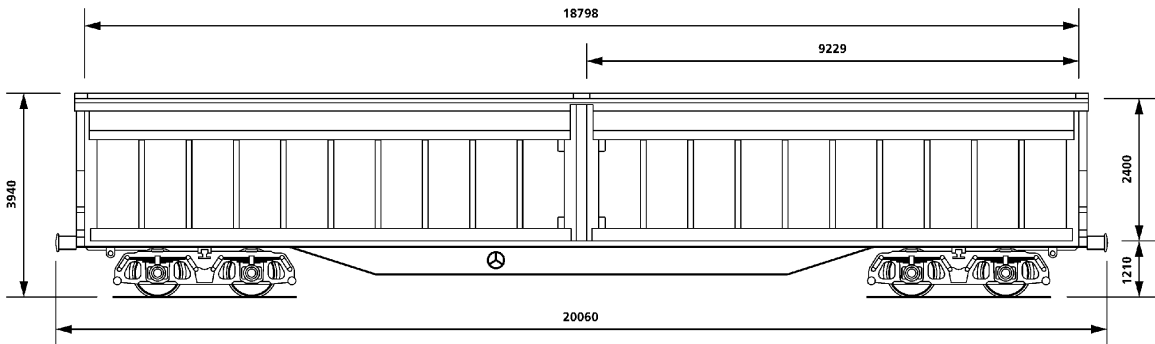

Wagon Data

Overall length (over buffers)	20.060mm
Overall height	3.940mm
Loading length	18.798mm
Loading width	2.500mm
Loading area	47 m2
Loading capacity	109m3
Length of door opening	9.229mm
Height of door opening	2.400mm
Platform height	1.210mm
Tare weight	26.500 kgs
Payload (axle load 20.0 tonnes)	53.500 kgs
Minimum curve	35 metres
Maximum speed	100 kph

Refer to separate table for height and width dimensions

Payload	A	B	C	
S	37.5	45.5	53.5	**
120	0.0			

GE121CT

Habfis/F2

